

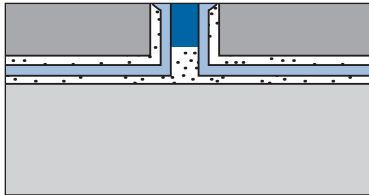

EXPANSION JOINT



Color	Great Lakes #	Qty/pkg	Size: in / mm	
Aluminum Black	GLM- EJBLK100	20	3/8	10
	GLM- EJBLK125	20	1/2	12.5
Gray	GLM- EJGY100	20	3/8	10
	GLM- EJGY125	20	1/2	12.5

A combination of 2 pieces of Clear finish (anodized) support legs joined by a polyurethane core. This allows the relief needed during the expansion and contraction of the substrate slab under the tile thus preventing the tile from cracking due to this movement.